



Antwerp Township Transfer & Recycling Station

(Operated by Best Way Disposal)

For Questions Call: 269.657.4101

(Prices and information effective April 1, 2012)



LOCATION

Entrance on the south side of 64th Avenue in Lawton, between CR 657 and 30th Street.

HOURS

Tuesday

10:00 am – 5:00 pm

Saturday

9:00 am – 4:00 pm

Note: The transfer station is CLOSED if a holiday falls on either business day.

ATTENDANT

Mike Latel

RECYCLABLE MATERIALS

There is no charge for RECYCLING for Antwerp Township Residents; non-Residents must pay \$2.00 each visit. Cash or check is acceptable for payment at the transfer station; purchasing script at Antwerp Township is no longer necessary. If you have any remaining script, you may use that for payment.

- ✓ Newspaper and newspaper inserts, phone books, magazines, catalogs
- ✓ Paperboard (i.e. cereal boxes and other like containers with no obvious wax coating or foil layer, remove any plastic windows and metal tear strips or spouts)
- ✓ Corrugated cardboard
- ✓ Glass (clear, brown, green – all lids, rims & spouts removed; no window glass)
- ✓ Plastic (#1 and #2 only)
- ✓ Aluminum; cans, sheet foil, and formed pans
- ✓ Tin cans
- ✓ Metal jar lids

This transfer station DOES NOT PERMIT liquids, oils, or hazardous waste (i.e. oil/latex paints, batteries). Contact the Kalamazoo County Household Hazardous Waste Center at 269.373.5211. The center is located at 1301 Lamont Avenue in Kalamazoo near the Kalamazoo County Fairgrounds. There is no fee for Antwerp Township residents.

NON-RECYCLABLE MATERIALS

Waste / 30-gallon plastic bags \$2.50 each

Waste / 55-gallon drums \$8.00 each

Waste / Pick-up truck & trailer loads:

	<u>IF LEVEL TO RAIL EDGE</u>	<u>IF LEVEL TO TOP OF CAB</u>
6 ft. truck bed or equiv. trailer	\$25.00	\$45.00
8 ft. truck bed or equiv. trailer	\$35.00	\$65.00
Shingles - 6 ft. truck bed	\$45.00 (1.5 yards)	\$84.00 (3 yards)
Shingles - 8 ft. truck bed (4 yards)	\$60.00 (2 yards)	\$120.00 (4 yards)

ANTWERP TOWNSHIP TRANSFER STATION

28251 64TH AVENUE

Lawton, MI 49065

Note: The transfer station operator will, at his discretion, adjust the load price depending on varying truck sizes and to what level they are full. Trailer loads and general refuse are measured and charged at \$16.00/cubic yard.

Furniture	\$18.00 each
Twin Mattresses or Box Springs	\$15.00 each or \$25.00/pr
Full Mattresses or Box Springs	\$20.00 each or \$40.00/pr
Queen or King Mattresses or Box Springs	Operators Discretion
Refrigerators – MUST be tagged with proof of freon removal	\$22.00 each
Stoves, washers, dryers, water heaters	\$22.00 each
Shingles	\$30.00/cubic yard

Directions From the Township Hall:

Head west on Front Avenue/CR 364, turn south/left on CR 657, turn west/right on 64th Avenue. The transfer station is on the south/left side of the road.

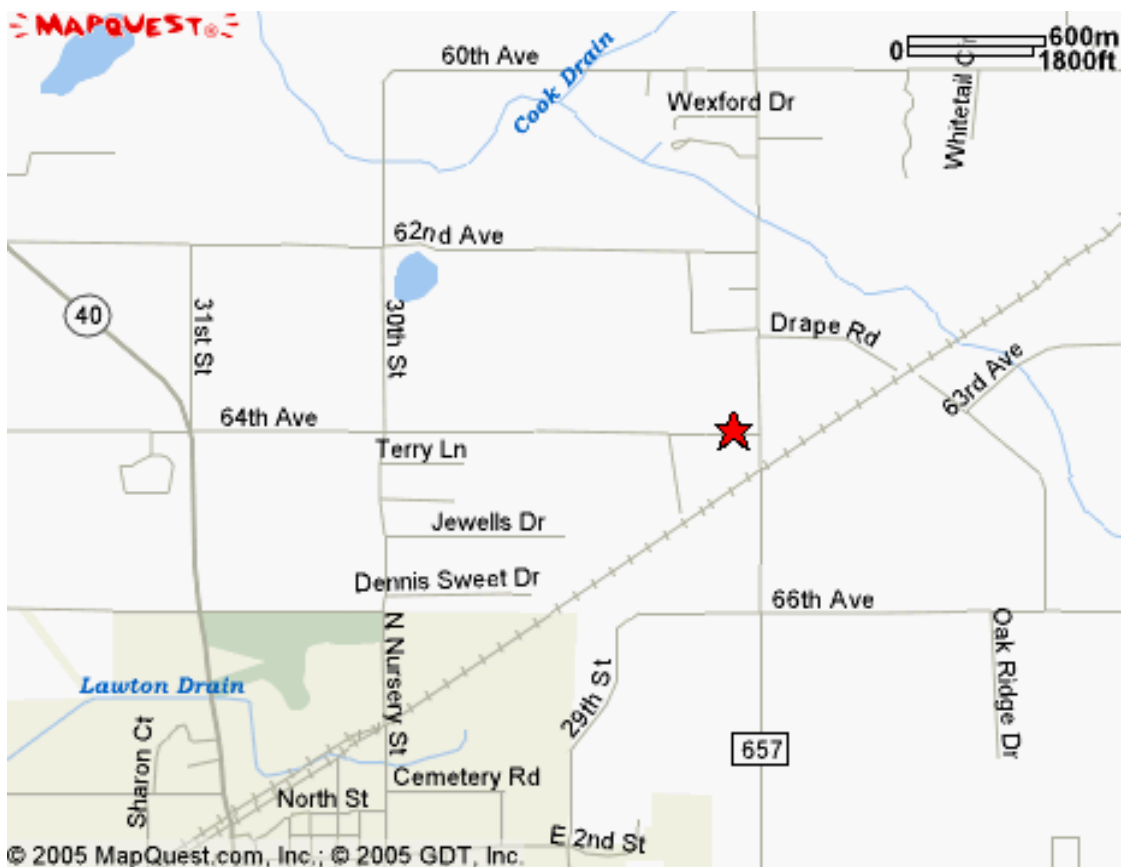

**ANTWERP TOWNSHIP TRANSFER STATION
28251 64TH AVENUE
Lawton, MI 49065**